

# Using the Amazon FireStick or Google ChromeCast with the Selfie Wizard

- The SW can wireless cast to any HDMI display that supports the Amazon FireStick and/or the Google ChromeCast with TV.
- Supports the use of a direct **Local** connection or from anywhere in the world over the internet using **Remote Access**.

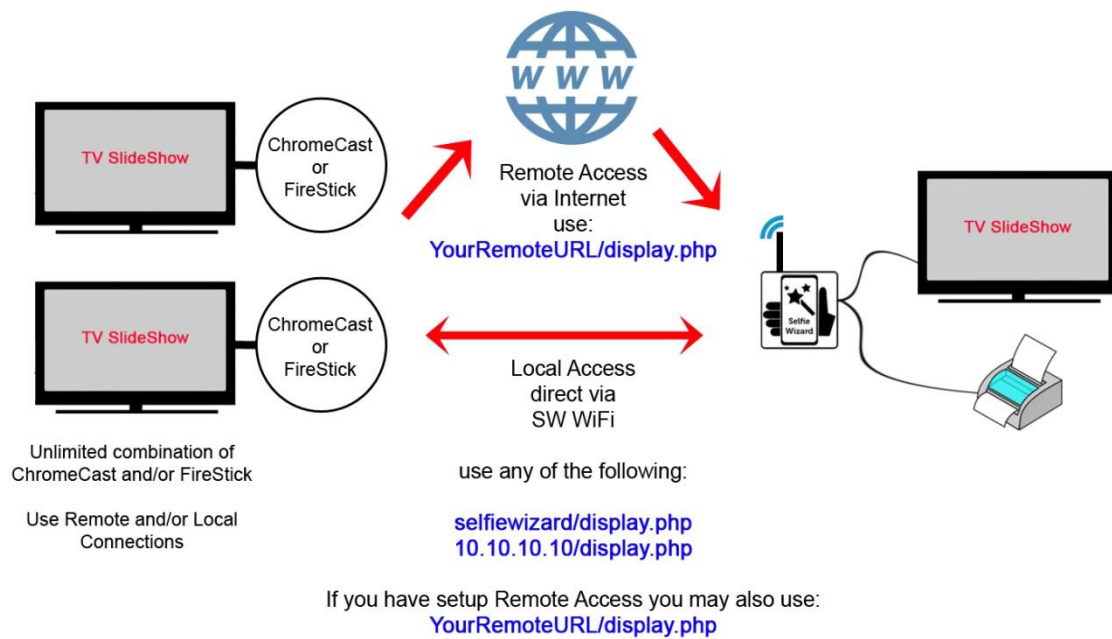

# Amazon FireStick

1. Follow the FireStick instructions for the initial setup on your TV and Home Wifi network.
2. Install the 'Downloader' App from the Amazon App Store.  
This App has a built-in fullscreen web browser.

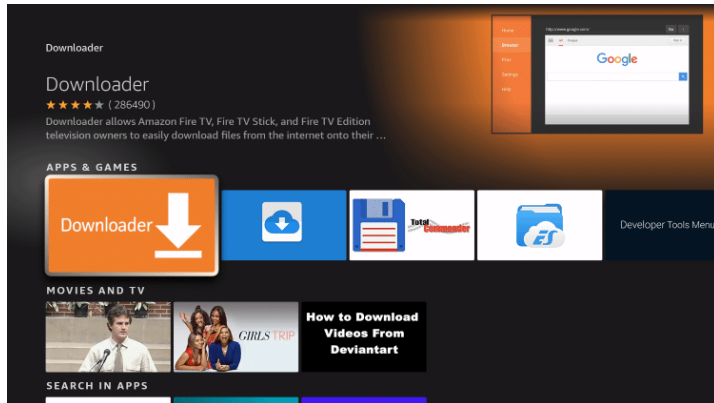

3. Remote Connection = Connect the FireStick to any WiFi Hotspot  
Local Connection = Connect the FireStick to the Selfie Wizard WiFi Network

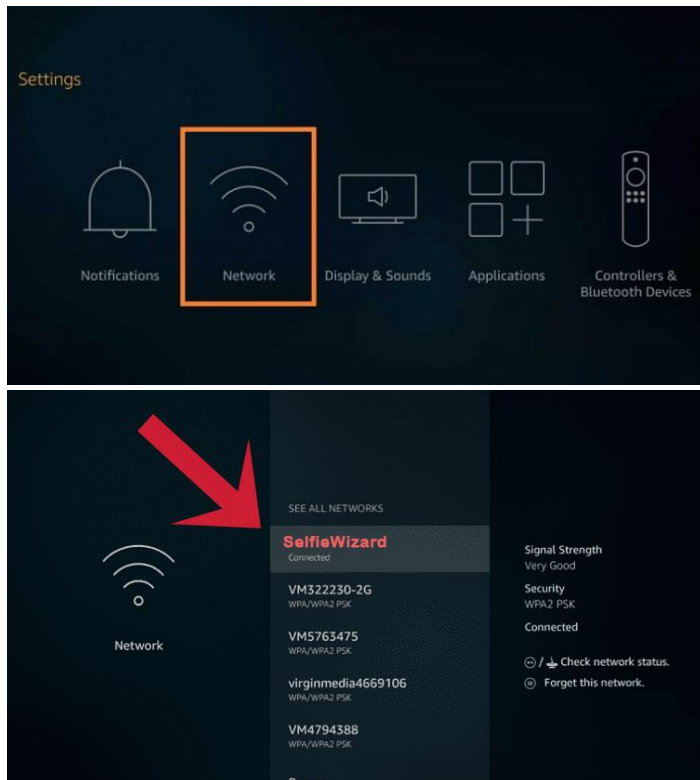

4. Open the Downloader App

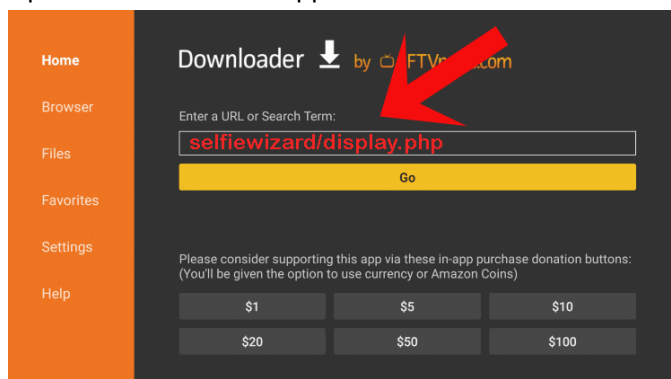

Local Connection = Use any of the following URL's:  
**selfiewizard/display.php**  
**10.10.10.10/display.php**

if you have setup your SW to use Remote Access  
the following will also work:  
**YourRemoteURL/display.php**

## Google ChromeCast

1. Follow the ChromeCast instructions for the initial setup on your TV and Home Wifi network.
2. Install the 'Web Page Presenter' App from the ChromeCast App Store.



3. Remote Connection = Connect the ChromeCast to any WiFi Hotspot  
Local Connection = Connect the ChromeCast to the Selfie Wizard WiFi Network

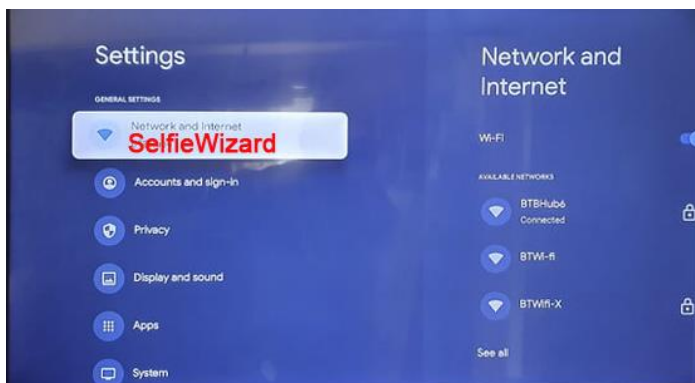

4. Open the Web Page Presenter App

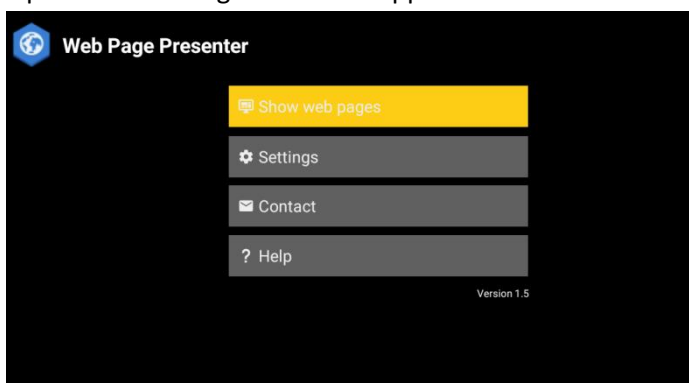

Local Connection = Use any of the following URL's:

**selfiewizard/display.php**

**10.10.10.10/display.php**

if you have setup your SW to use Remote Access the following will also work:

**YourRemoteURL/display.php**